

FILE NAME: G:\PROJ\06558026\PROJECTS\SOL AND COVE ROADWAY\CIVIL\SHEETS\C-200 - GRADING & DRAINAGE PLAN.DWG  
 TIME: 17 NOV 2021 - 3:14PM  
 USER: NICKEL

CONTINUED ON SHEET C-200

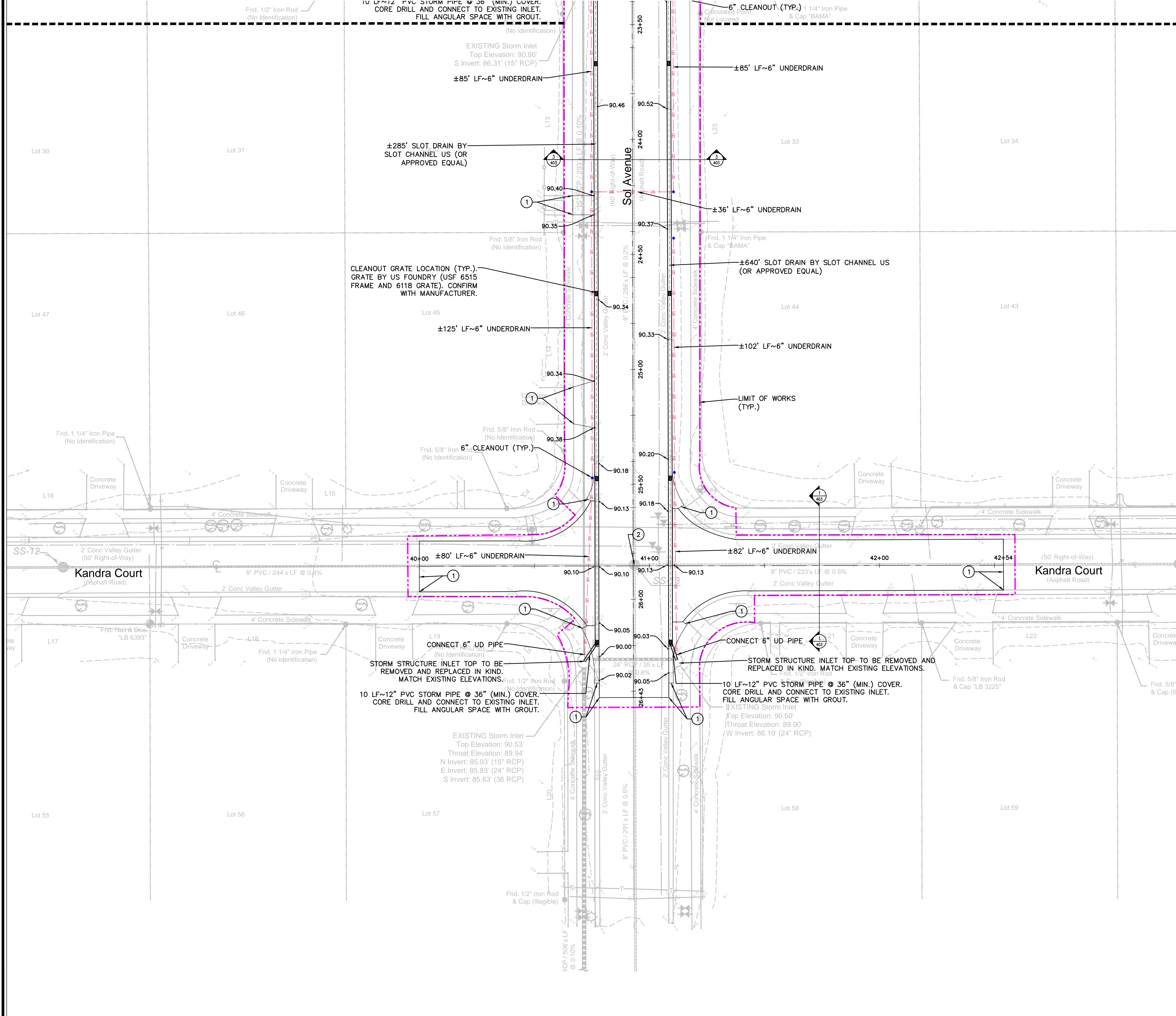

**LEGEND**

- LIMIT OF WORK
- 92.56 FINISHED GRADE ELEVATION
- GRADING ITEM KEY NOTE IDENTIFICATION. SEE TABLE THIS SHEET
- 6" UNDERDRAIN PIPE
- CLEANOUT

**NOTES:**

1. CONTRACTOR TO FOLLOW EXISTING ROAD FLOW PATTERN & ELEVATION UNLESS OTHERWISE NOTED ON PLANS.
2. CONTRACTOR MATCH EXISTING PAVEMENT ELEVATIONS AT PAVEMENT LIMIT.
3. CONTRACTOR SHALL RESET ALL EXISTING VALVE BOXES/COVERS AS NECESSARY TO FINISHED GRADE.
4. EXISTING UTILITIES SHOWN FOR REFERENCE. CONTRACTOR TO USE CAUTION WHEN DIGGING.

GRADING KEY NOTE	
KEY NUMBER	DESCRIPTION
1	MEET EXISTING CURB GUTTER AND EDGE OF PAVEMENT ELEVATIONS.
2	SANITARY MANHOLE TO REMAIN. MEET EXISTING RIM ELEVATION.

ELEVATION SPOT GRADES ADDED

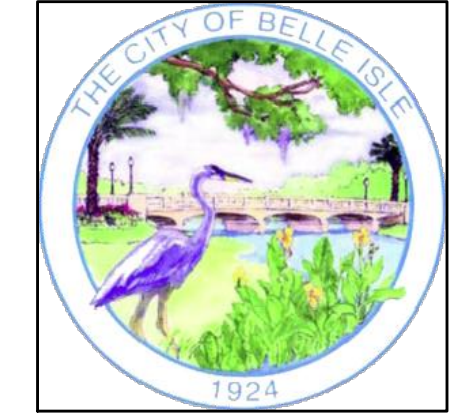
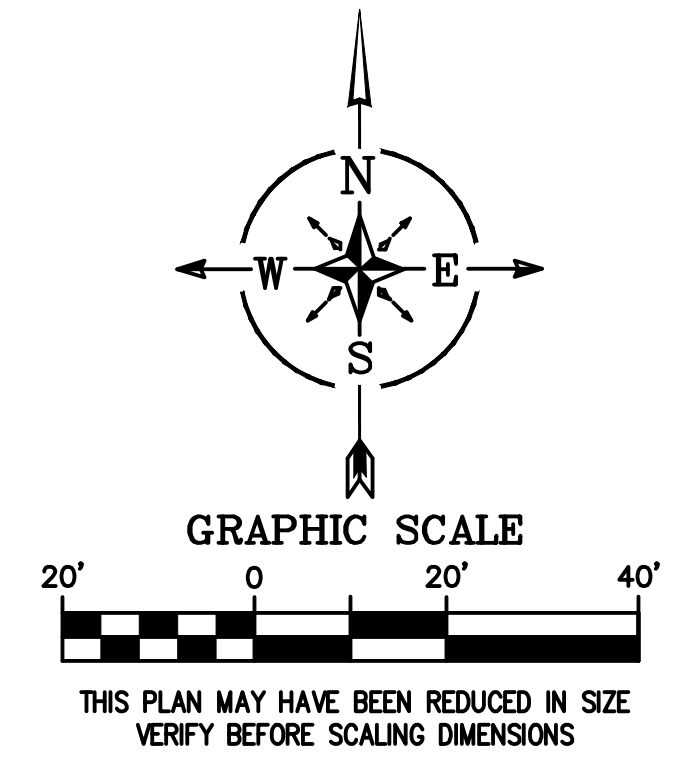
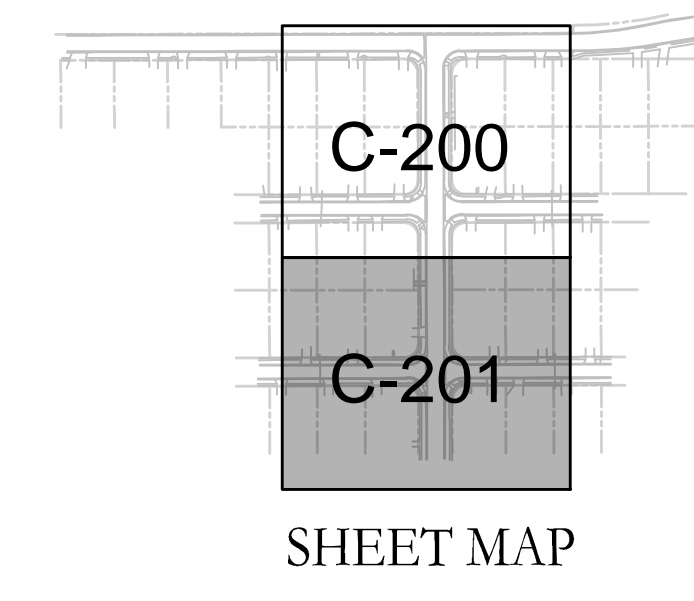

**HARRIS**  
 Harris Civil Engineers, LLC  
 1200 Hillcrest Street  
 Suite 200  
 Orlando, Florida 32803  
 Phone: (407) 629-4777  
 Fax: (407) 629-7888  
 www.harriscivilengineers.com  
 EB 9814

**COVE DRIVE & SOL AVENUE  
 ROADWAY IMPROVEMENTS**  
 City of Belle Isle  
 1600 Nela Avenue  
 Belle Isle, Florida 32809

**Revisions:**

No.	Date	REVISION PER BIDDING COMMENTS
A	11/17/21	

**GRADING & DRAINAGE PLAN**

Scale: SEE SCALE BAR    Design: NZL  
 Date: 10/14/2021    Drawn: NZL  
 Project No: 06558026    Checked: DWT

Release:

**C-201**

COPYRIGHT © 2017 ALL SCALE ARRANGEMENTS AND PLANS INDICATED OR REPRESENTED BY THE DRAWING ARE OWNED BY AND THE PROPERTY OF HARRIS CIVIL ENGINEERS, LLC AND WERE CREATED, DEVELOPED AND DESIGNED FOR USE WITH THE SPECIFIED PROJECT. HARRIS CIVIL ENGINEERS RESERVES COPYRIGHTS AND OTHER RIGHTS RESTRICTING THE DRAWING TO THE ORIGINAL PROJECT OR PURPOSE FOR WHICH THEY WERE PREPARED. REPRODUCTIONS, CHANGES OR ASSIGNMENTS ARE PROHIBITED WITHOUT THE WRITTEN PERMISSION OF HARRIS CIVIL ENGINEERS.